

SPECIFICATIONS

PRODUCT SPECIFICATIONS

Preliminary

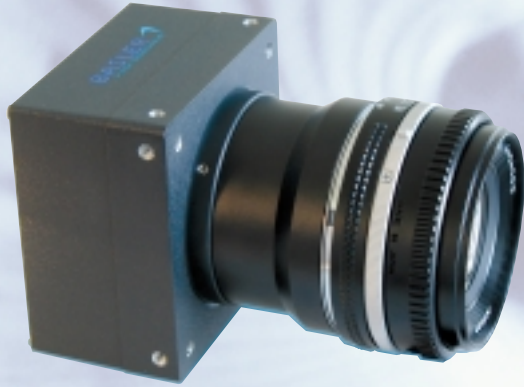

DIGITAL CCD LINE SCAN
8160 PIXELS
MONOCHROME
CAMERA LINK® OUTPUT
LINE RATES UP TO 14.4 KHZ

BASLER L800 SERIES

Features/Benefits

- High resolution lets you inspect for smaller defects and provides an exceptional price/performance ratio
- Superior image quality improves your image processing results
- Super compact size reduces the space needed in your installation
- 100% factory testing ensures consistent product quality
- LED indicators and test image generation capability reduce your integration time and aid troubleshooting
- Windows® setup tool lets you configure your camera with ease
- Electronic exposure time control provides maximum flexibility
- Useful new features such as a line sum, a line counter, and shading correction enhance your range of application solutions

Description

The L800 Series of digital line scan cameras is designed for industrial users who require high resolution and superior image quality with high-speed data acquisition. The cameras can be triggered via an external sync signal or run in an internally controlled "free-run" mode. L800 cameras operate with a single voltage power supply and have simple cabling requirements. The combination of features available on L800 cameras makes them easy to use and exceptionally capable.

Applications

- Printed circuit board inspection
- Flat panel display inspection
- Postal sorting & document scanning
- Print inspection
- Web inspection
- Food inspection
- Many other vision applications

Dimensions (in mm)

L800 Series

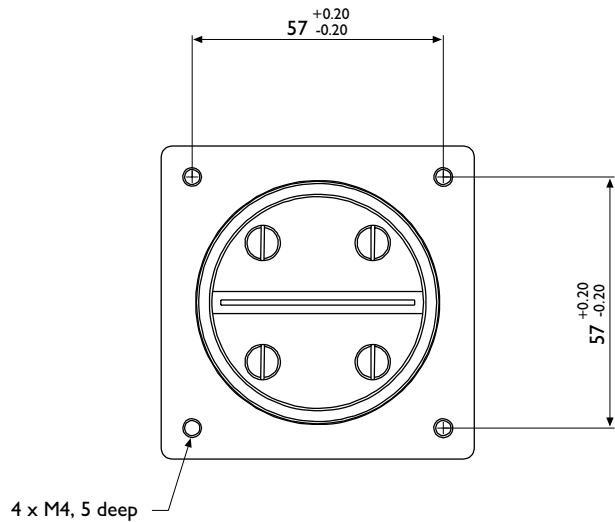
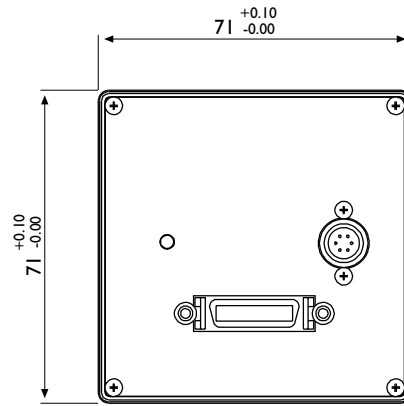
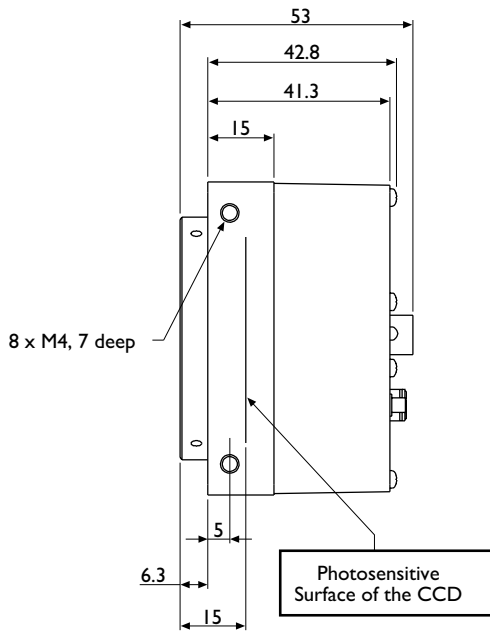

Specifications	L801k	L802k	L803k
Sensor Size	8160 pixels		
Sensor Type	Linear CCD		
Pixel Size	5 μm x 5 μm (5 μm pitch)		
Camera Link Pixel Clock (MHz)	20	40	60
Max. Data Rate (MPixels/s)	37	75	112
Max. Line Rate (KHz)	4.8	9.6	14.4
Pixel Depths	Selectable 8 bit or 10 bit		
Video Output Formats	Dual tap 8 bit or dual tap 10 bit		
Synchronization	Via external signal or free run		
Exposure Control Models	Edge-controlled, level controlled, or programmable		
Power Requirements	12 VDC +/- 10%		
Lens Mounts	F-mount		
Housing Size (L x W x H)	47.6 mm x 71.0 mm x 71.0 mm		
Weight	~ 300 g (without F-mount adapter)		
Conformity	CE and FCC		

Specifications are subject to change without prior notice.



Germany, Headquarters
 Phone +49 4102 463 500
 Fax +49 4102 463 599
 vc.sales.europe@baslerweb.com

USA
 Phone +1 610 280 0171
 Fax +1 610 280 7608
 vc.sales.usa@baslerweb.com

Singapore
 Phone +65 6425 0472
 Fax +65 6425 0473
 vc.sales.asia@baslerweb.com

www.basler-vc.com