

SPECIFICATIONS

PRODUCT SPECIFICATIONS



DIGITAL CMOS AREA SCAN
1.3 MEGAPIXELS
MONOCHROME
IEEE 1394 OUTPUT
25 FPS AT FULL RESOLUTION

BASLER A620 SERIES

Features/Benefits

- High image quality improves your image processing results
- Ultra compact size reduces the space needed in your installation
- 100% factory testing ensures consistent product quality
- When combined with the BCAM 1394 Driver and a standard IEEE 1394 adapter, these cameras offer a plug and play solution for industrial quality digital video
- Electronic exposure time control provides maximum flexibility

Description

The A620 Series of high-performance, 1.3 megapixel resolution, digital cameras is ideal for price sensitive users seeking the advantages of digital video. The cameras can be triggered via an external sync signal or run in an internally controlled "free-run" mode. A622f cameras operate with a single voltage power supply and have the advantages of the standard cabling and adapter requirements of IEEE 1394. A combination of features such as AOI scanning and test images ensure that these versatile cameras provide an exceptional price/performance ratio.

Applications

- Semiconductor and component inspection
- Manufacturing quality control
- Intelligent Traffic Systems (ITS)
- Microscopy and medical imaging
- Many other vision applications

Dimensions (in mm)

A622f (IEEE 1394)

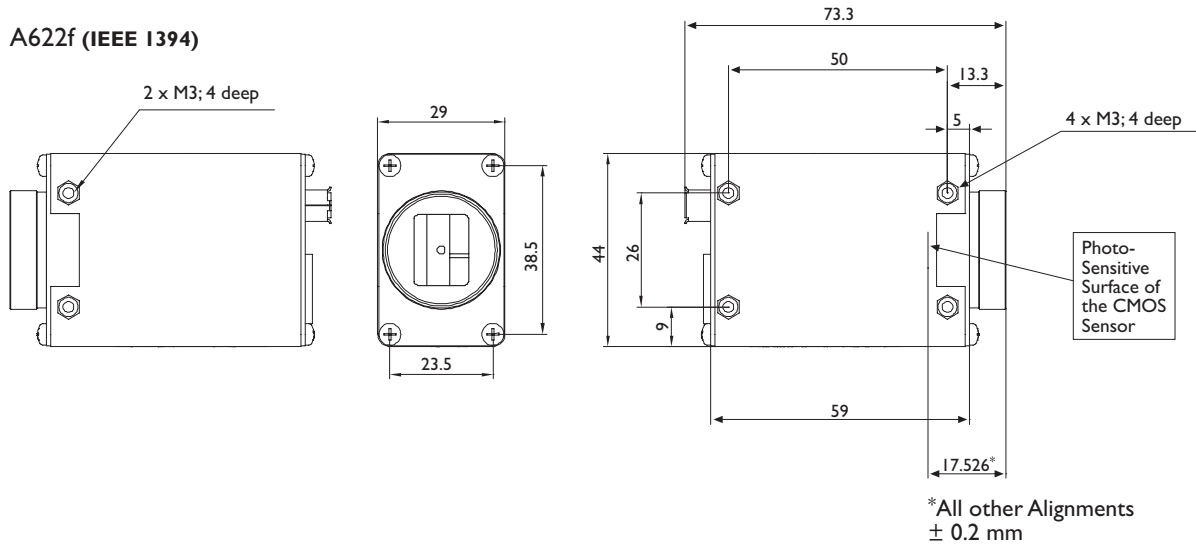

Specifications	A622f
Sensor Size (H x V Pixels)	1280 x 1024
Sensor Type	2/3" Progressive Scan CMOS, global shutter, non-overlap
Pixel Size	6.7 μm x 6.7 μm
Max. Frame Rate at Full Resolution	25 fps
Video Output Format	Mono: 8 or 16 (10 bit/pixel)
Color / Mono	Mono
Video Output Type	IEEE 1394
Synchronization	Via external trigger or the 1394 bus
Exposure Control	Programmable via the 1394 bus
Power Requirements	+8 to +36 VDC (12VDC nominal) max. ~ 2.5 W
Lens Mount	C-mount
Housing Size (L x W x H)	67.3 mm x 44 mm x 29 mm
Weight	max. 100 g (typical)
Conformity	CE, FCC

Specifications are subject to change without prior notice.

BASLER
VISION TECHNOLOGIES

Germany, Headquarters
Phone +49 4102 463 500
Fax +49 4102 463 599
vc.sales.europe@baslerweb.com

USA
Phone +1 610 280 0171
Fax +1 610 280 7608
vc.sales.usa@baslerweb.com

Singapore
Phone +65 6425 0472
Fax +65 6425 0473
vc.sales.asia@baslerweb.com

www.basler-vc.com